

2000  
Davis & Van Buren Counties, Iowa  
Iowa South Zone (1402)  
NAD\_83(1996)

Point Number: 161

Northing: 275980.01(Ft)      Easting: 2067855.57(Ft)

Northing: 84118.874(M)      Easting: 630283.637(M)

Elev: 673.54(Ft) NAVD\_88

Elev: 205.306(M) NAVD\_88      Ellip Ht: 172.238(M)      96C Geoid Ht: -33.069(M)

Latitude: 40-44-49.536166 N      Longitude: 91-57-26.155302 W

Theta: 1-00-58.32      Combination Factor: 0.99995251

Designation: VAN BUREN CO GPS CONTROL PT 2000-161

**Monument Type:** 5/8" dia driven aluminum rod with a 2-1/2" dia aluminum cap and permanent magnet encased in a 5" dia PVC pipe with an aluminum access cover.

**To Reach:** Near the Van Buren County Highway Dept. office building, near the center of Sec 25 T69N R10W.

Date Printed July 25, 2000

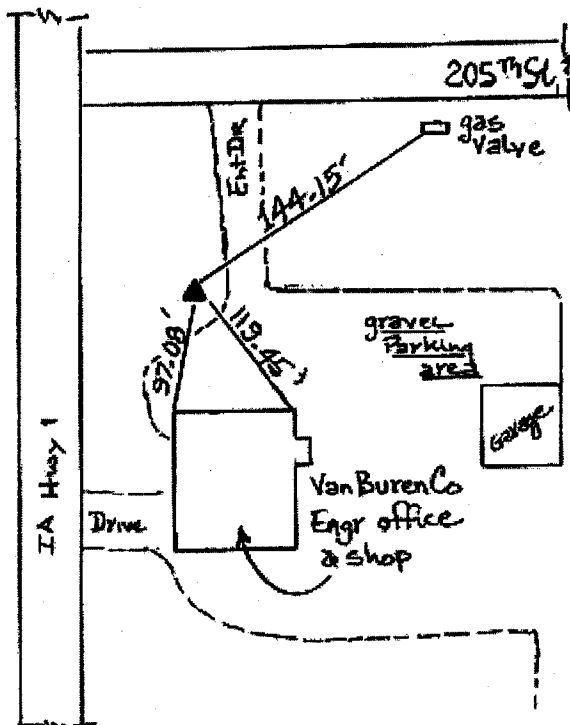

↑  
N  
2000-161  
Jun 7, 2000